

**SEZIONE ORIZZONTALE B-B**

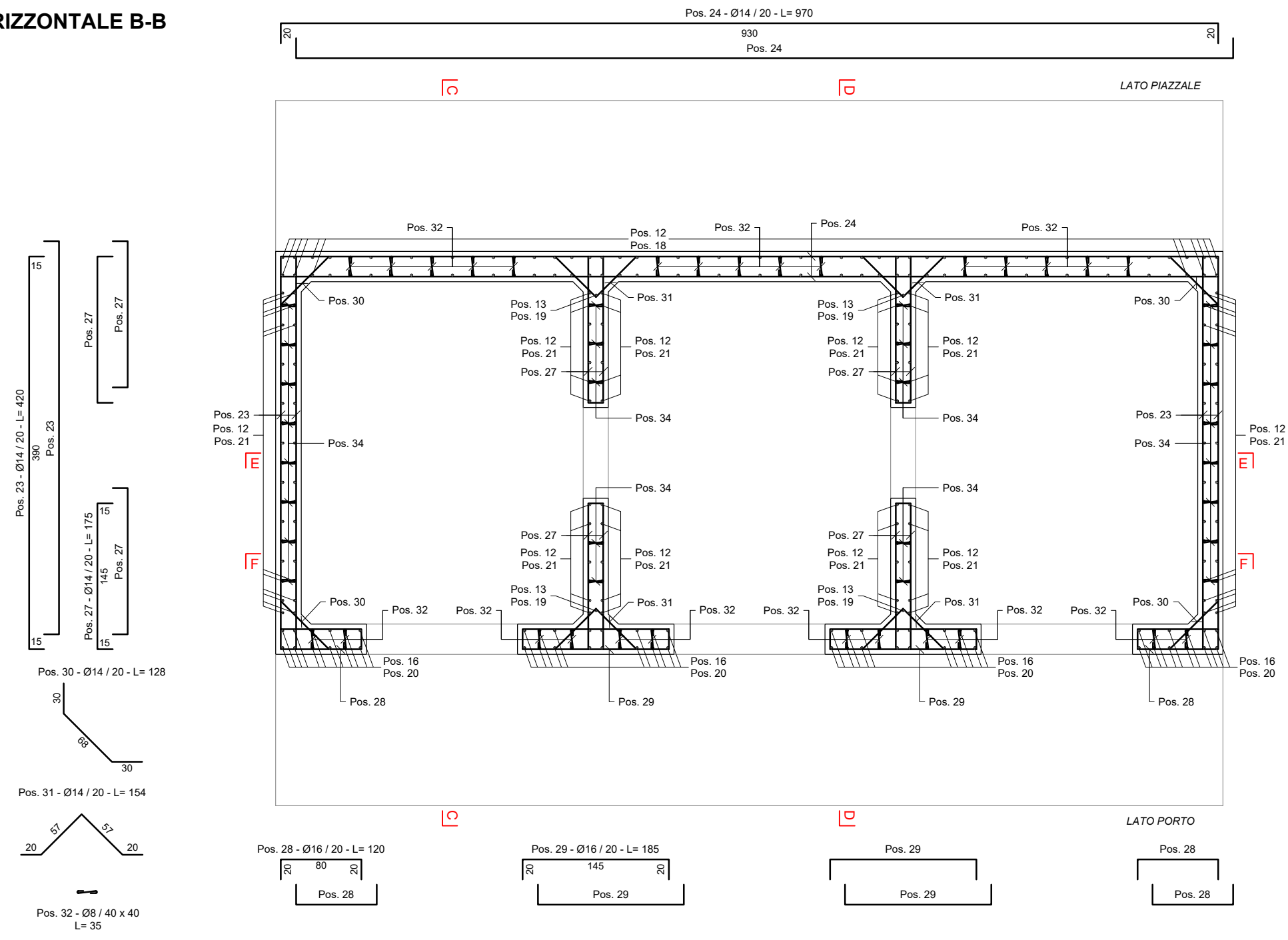

**SEZIONE VERTICALE D-D**

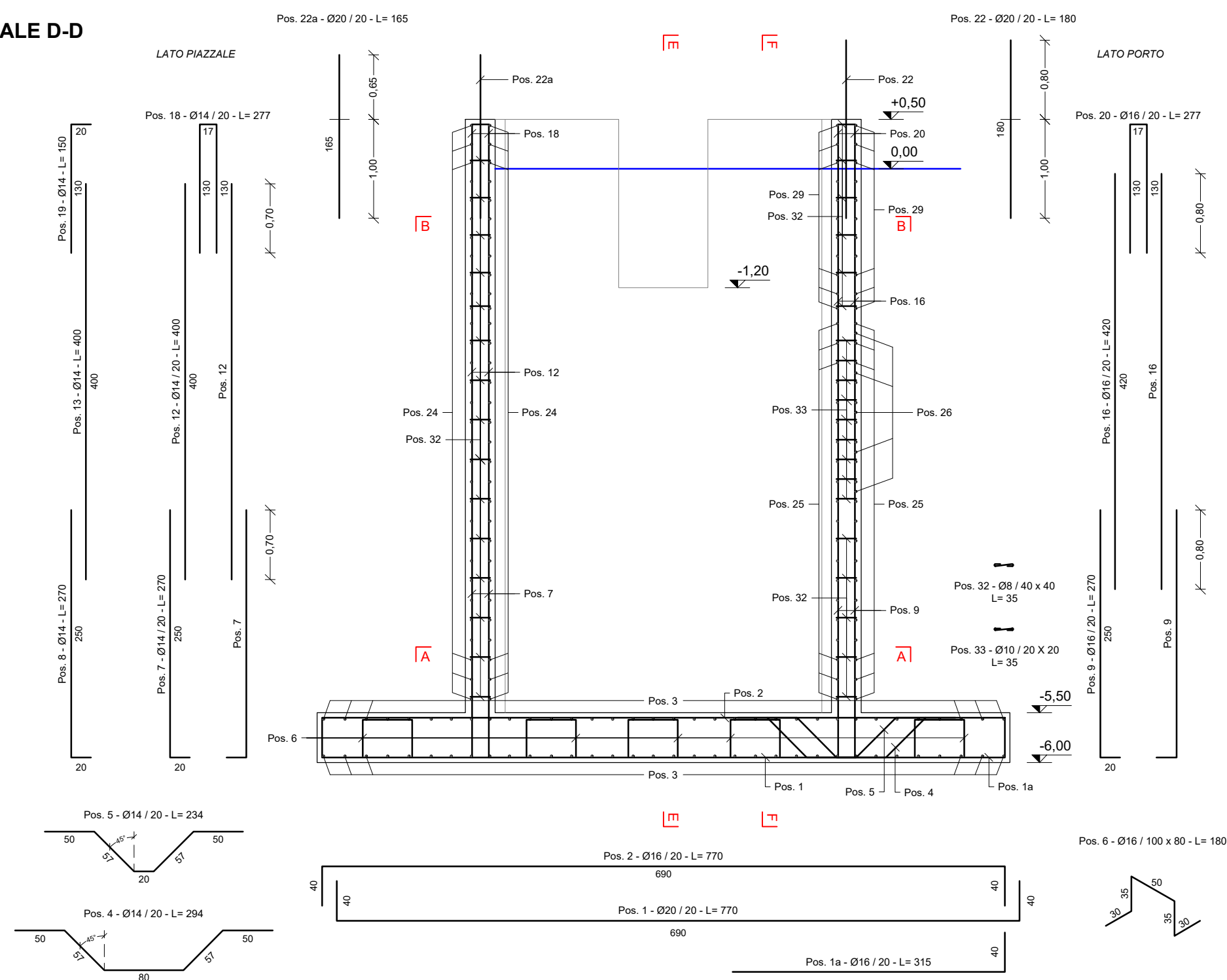

**SEZIONE VERTICALE F-F**

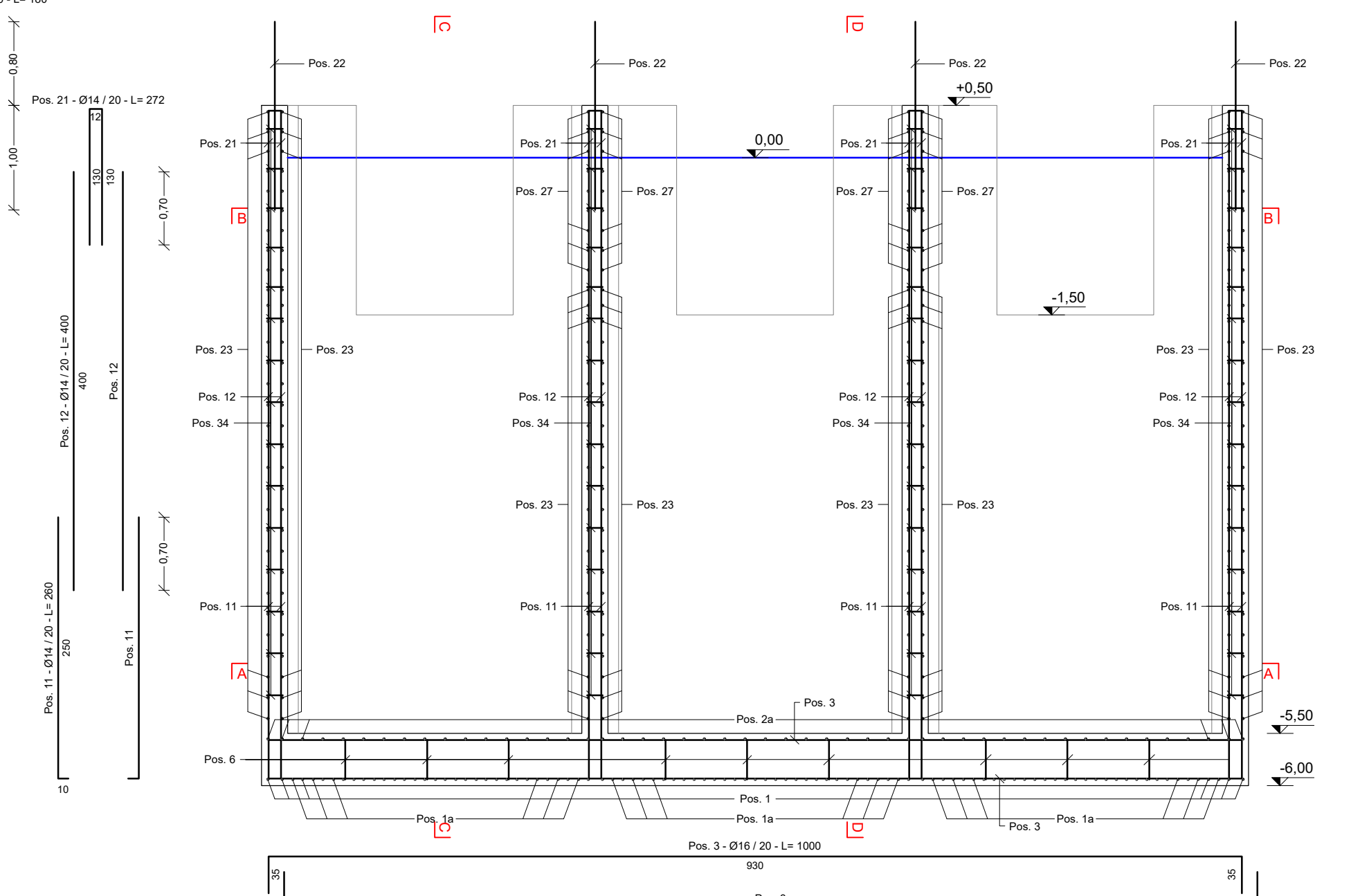

CARATTERISTICHE DEI MATERIALI	
CALCESTRUZZO	C 35/45
ACCIAIO	B 540 C
CLASSE DI ESPOSIZIONE	XS 3
RAPPORTO A/C	<0.45
DIAMETRO MASSIMO INERTE	32 mm
COPRIFERRO SOLETTONE	5 cm
COPRIFERRO PARETI E SETTI	5 cm
CLASSE DI CONSISTENZA	S4/S5
CONTENUTO MINIMO DI CEMENTO	360 kg/m <sup>3</sup>
UNITA' DI MISURA	
CARPENTERIE IN "m"	
FERRI D'ARMATURA IN "cm"	

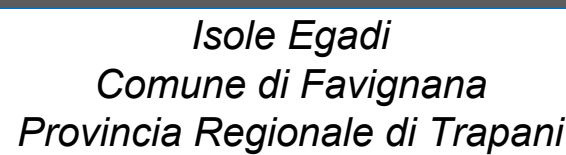

## An aerial photograph of a coastal town. The town is built on a peninsula or near the coast, with a harbor area in the center. The water is a deep blue-green color. The town itself is densely packed with buildings, mostly with light-colored roofs. To the left of the town, there are large, flat, brownish fields, possibly agricultural. The coastline is irregular, with some small bays and inlets. The overall scene is a mix of urban development and natural landscape.

PROGETTO ESECUTIVO - 1° STRALCIO FUNZIONALE

**Responsabile Unico del Procedimento:**  
*Ing. Salvatore Caruso*

**Il Progettista delle strutture**  
**DUOMI S.r.l.**  
*Inq. Guglielmo Migliorino*



Titolo elaborato :

### Cassone Tipo G1: Armature

DATA	DESCRIZIONE	N°/SIGLA							REV	SCALA
11/12/2019	EMISSIONE REVISIONE 1	P	E	-	0	2	3	3	1	1:50